

## Verify

Review the document for accuracy. If you have questions or concerns, or need additional information, contact us at 1-888-IASKNMC or IASKNMC@uscg.mil.

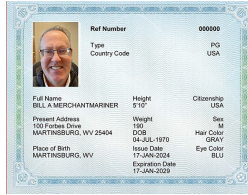

## Sign

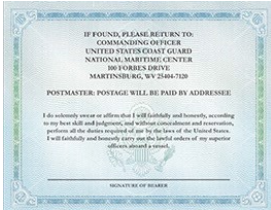

Your new mariner credential will not be valid without your signature. **Sign it** using a black or blue ballpoint pen as soon

as it arrives. **Do not** use a permanent marker or gel-type pen as the ink may smear before it dries.

## Protect

Your MMC cannot be used as a passport, but should be protected as you would a passport. **Do not** laminate your MMC.

## Secure

Your MMC is printed with security features for fraud protection and is printed on **waterproof, tear-resistant** synthetic paper. Do not attempt to modify the document in any way.

## For more information contact the NATIONAL MARITIME CENTER

Commanding Officer  
United States Coast Guard  
National Maritime Center  
100 Forbes Drive  
Martinsburg, WV 25404

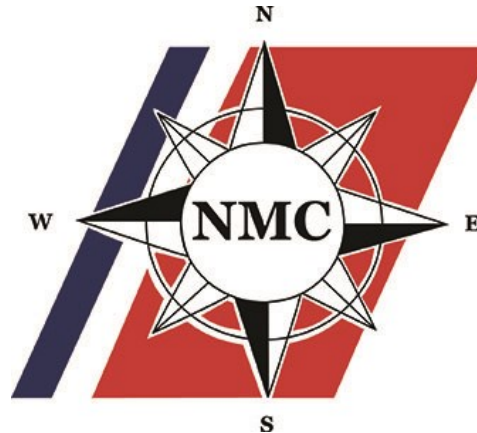

Visit us on the web at:  
<https://www.uscg.mil/nmc/>

1-888-IASKNMC  
(1-888-427-5662)  
IASKNMC@uscg.mil  
Live Chat

## Your NEW Merchant Mariner Credential (MMC)



Learn about  
your new  
**MMC**

# What to Check

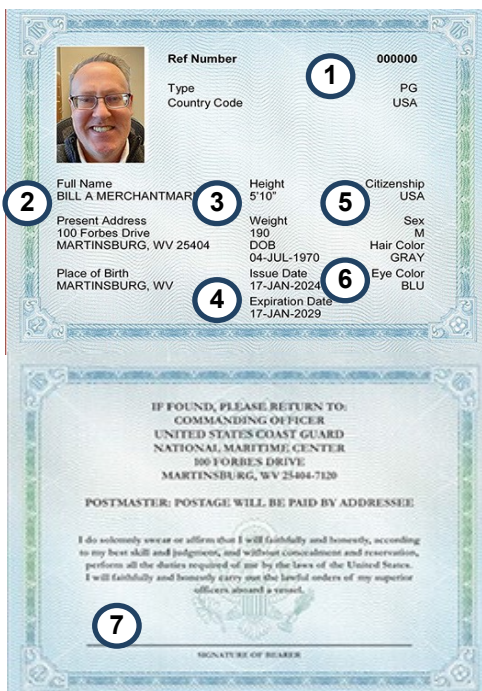

## Personal Information:

1. Mariner reference number, credential type code and country of origin
2. Name, address, and place of birth
3. Height, weight, and date of birth
4. Date of issuance and date of expiration
5. Citizenship
6. Sex, hair color, and eye color
7. Signature line—Your document is not valid without a signature

**Be sure that your name is shown correctly everywhere it appears in the document.**

## Endorsement and Limitation Information:

1. National Header
2. National Capacity
3. National Limitations
4. STCW Header
5. STCW Capacity
6. STCW Limitations
7. Signature of Authorizing Official

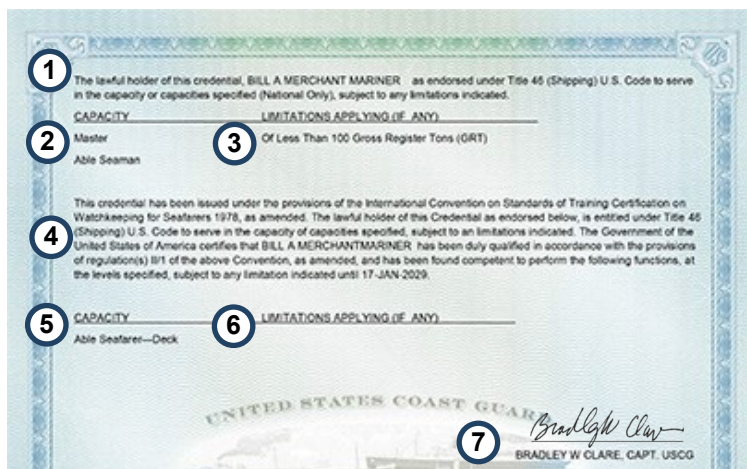

Your new MMC is designed in a one-page, front & back format. It may be displayed flat or folded. Folding your MMC is optional. The new MMC replaces the passport-style book & associated endorsement labels. The MMC document number is found in the white box below the barcode.

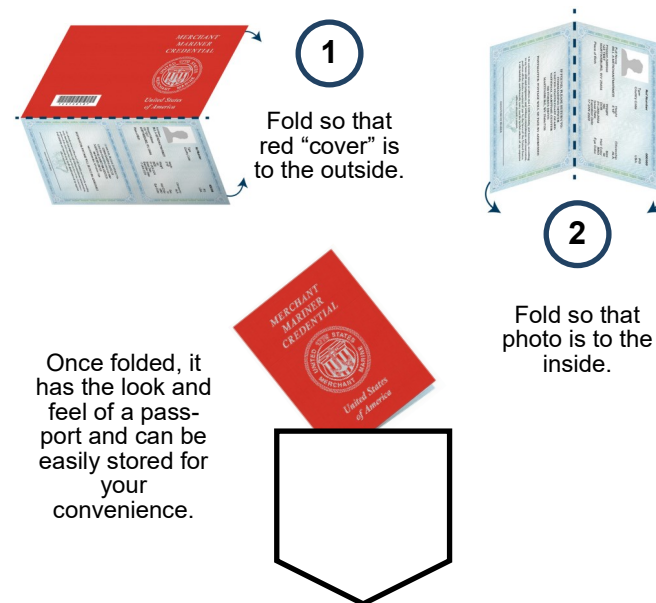

Once folded, it has the look and feel of a passport and can be easily stored for your convenience.